

TYPE FREEHOLD
PURPOSE SUBDIVISION
PLAN OF

LOTS 109-114, 8010, 9003, 9004
ROADS AND EASEMENTS

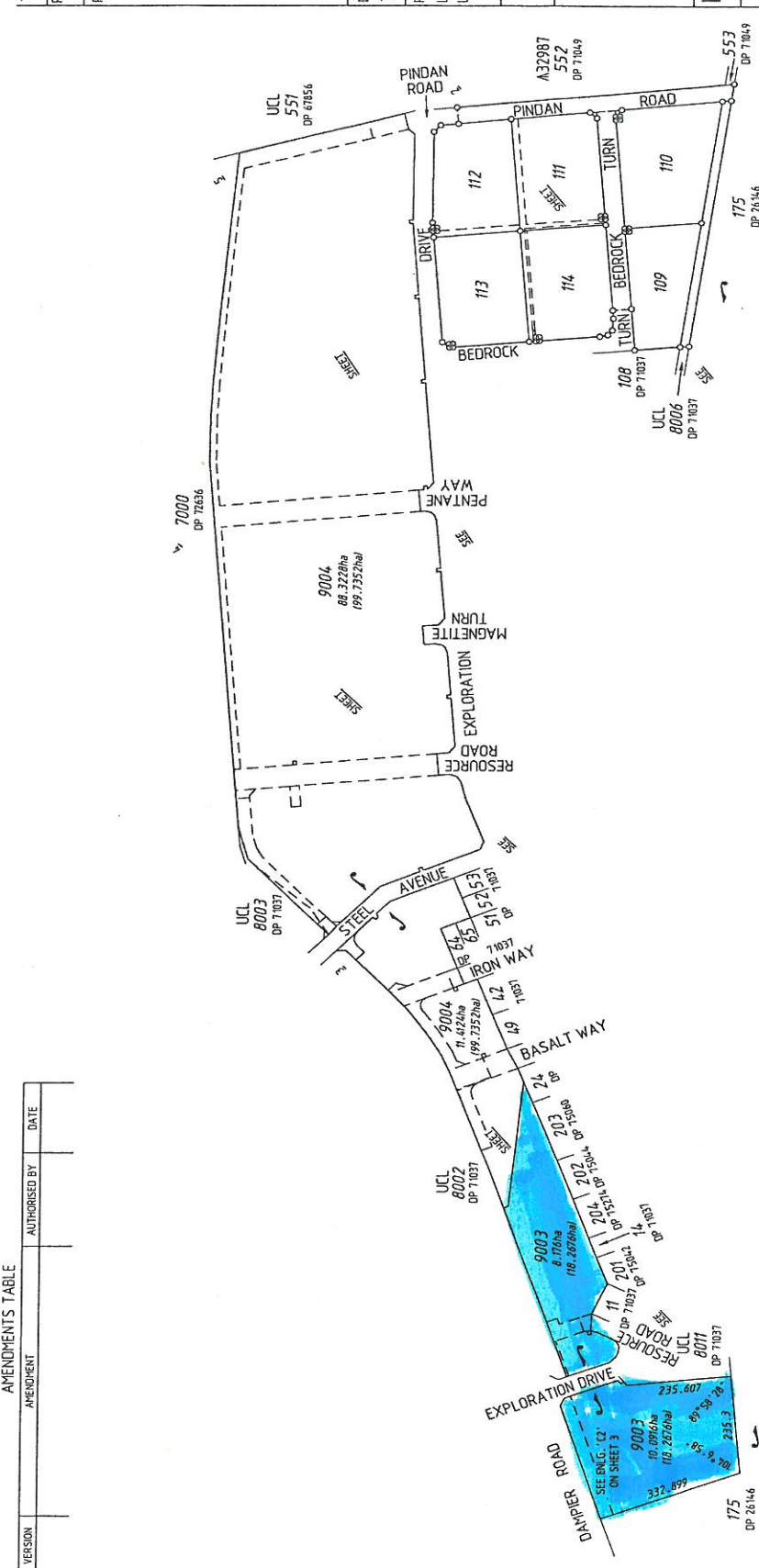

DATE: 2012.04.12
TIME: 12:45:18
BY: Mark P. Marotti
FOR: 1:8000 at A2
SCALE: 1:8000 at A2
MNG Ref: 956140p-075b
Stage 3 - DP15061.150

LOGGED: 2-Dec-12
DATE: 2012.04.12
TIME: 12:45:18
BY: Mark P. Marotti
FOR: 1:8000 at A2
SCALE: 1:8000 at A2
MNG Ref: 956140p-075b
Stage 3 - DP15061.150

APPROVED BY: 140884
WESTERN AUSTRALIAN PLANNING COMMISSION

IN ORDER FOR DEALINGS

DATE: 2012.04.12
TIME: 12:45:18
BY: Mark P. Marotti
FOR: 1:8000 at A2
SCALE: 1:8000 at A2
MNG Ref: 956140p-075b
Stage 3 - DP15061.150

APPROVED: REC26A (4)

DATE: 2012.04.12
TIME: 12:45:18
BY: Mark P. Marotti
FOR: 1:8000 at A2
SCALE: 1:8000 at A2
MNG Ref: 956140p-075b
Stage 3 - DP15061.150

INTERESTS AND NOTIFICATIONS					FORMER TENURE TABLE		
SUBJECT	PURPOSE	STATUTORY REFERENCE	ORIGIN	LAND BURDENED	BENEFIT TO	COMMENTS	
(33b)	EASEMENT (Drainage)	SEC 167 OF THE P & D ACT REG 33 (b)	DP 71037	LOT 9003	WATER CORPORATION		
(33b) 8	EASEMENT (Water Supply)	SEC 167 OF THE P & D ACT REG 33 (b)	DP 71037	LOT 9003	WATER CORPORATION		
(33c) 3	EASEMENT (Electricity Supply)	SEC 167 OF THE P & D ACT REG 33 (c)	DP 71037	LOT 9003	REGIONAL POWER CORPORATION		
(L)	EASEMENT	ENERGY OPERATORS (POWERS) ACT 1979	DOC LB00235	LOT 9003	REGIONAL POWER CORPORATION		
(33b) 1, (33b) 2	EASEMENT (Drainage)	SEC 167 OF THE P & D ACT REG 33 (b)	DP 71037	LOT 9004	SHIRE OF RIBBOURNE		
(33b) 1, (33b) 6	EASEMENT (Sewerage)	SEC 167 OF THE P & D ACT REG 33 (b)	DP 71037	LOT 9004	WATER CORPORATION		
(33b) 7	EASEMENT (Sewerage)	SEC 167 OF THE P & D ACT REG 33 (b)	DP 71037	LOT 114	WATER CORPORATION		
(33b) 4, (33b) 9	EASEMENT (Water Supply)	SEC 167 OF THE P & D ACT REG 33 (b)	DP 71037	LOT 9004	WATER CORPORATION		
(33c) 10, (33b) 11	EASEMENT (Water Supply)	SEC 167 OF THE P & D ACT REG 33 (b)	DP 71037	LOT 9004	REGIONAL POWER CORPORATION		
(33c) 1, (33c) 2, (33c) 4	EASEMENT (Electricity Supply)	SEC 167 OF THE P & D ACT REG 33 (c)	DP 71037	LOT 9004	REGIONAL POWER CORPORATION		
(G)	EASEMENT	ENERGY OPERATORS (POWERS) ACT 1979	DOC LB00234	LOT 9004	REGIONAL POWER CORPORATION		
(33a) 3	EASEMENT (Drainage)	SEC 167 OF THE P & D ACT REG 33 (b)	THIS PLAN	LOTS 111, 112, 114	SHIRE OF RIBBOURNE		
(33b) 2	EASEMENT (Sewerage)	SEC 167 OF THE P & D ACT REG 33 (b)	THIS PLAN	LOTS 111, 114	WATER CORPORATION		
LOT 8010	RESERVE FOR DRAINAGE	VESTS IN THE CROWN UNDER SEC 152 OF THE P & D ACT	THIS PLAN	LOTS 109-114			
	NOTIFICATION	SEC 70A OF THE TLA	DOC	LOTS 109-114			
	NOTIFICATION	SEC 70A OF THE TLA	DOC	LOTS 109-114			

LOT	FORMER TENURE	ON PLAN / DIAGRAM	TITLE
9003	PT LOT 9001	DP 71037	2192-864
111-114, 9004	PT LOT 9002	DP 71037	2191-383
109, 110	PT LOT 9003	DP 71037	2192-864
	PT LOT 9002	DP 71037	2191-383

HELD BY LANDGATE
IN DIGITAL FORM ONLY.

 **Landgate**
Western Australian Land Information Authority



FORMER TENURE TABLE			
LOTS	FORMER TENURE	ON PLAN / DIAGRAM	TITLE
9006	PT LOT 9004	DP 15661	
9, 33, 35-37, 9005	PT LOT 9003	DP 15661	
	PT LOT 9003	DP 15661	
29-31, 1032, 2000	PT LOT 9004	DP 15661	

FORMER TENURE TABLE

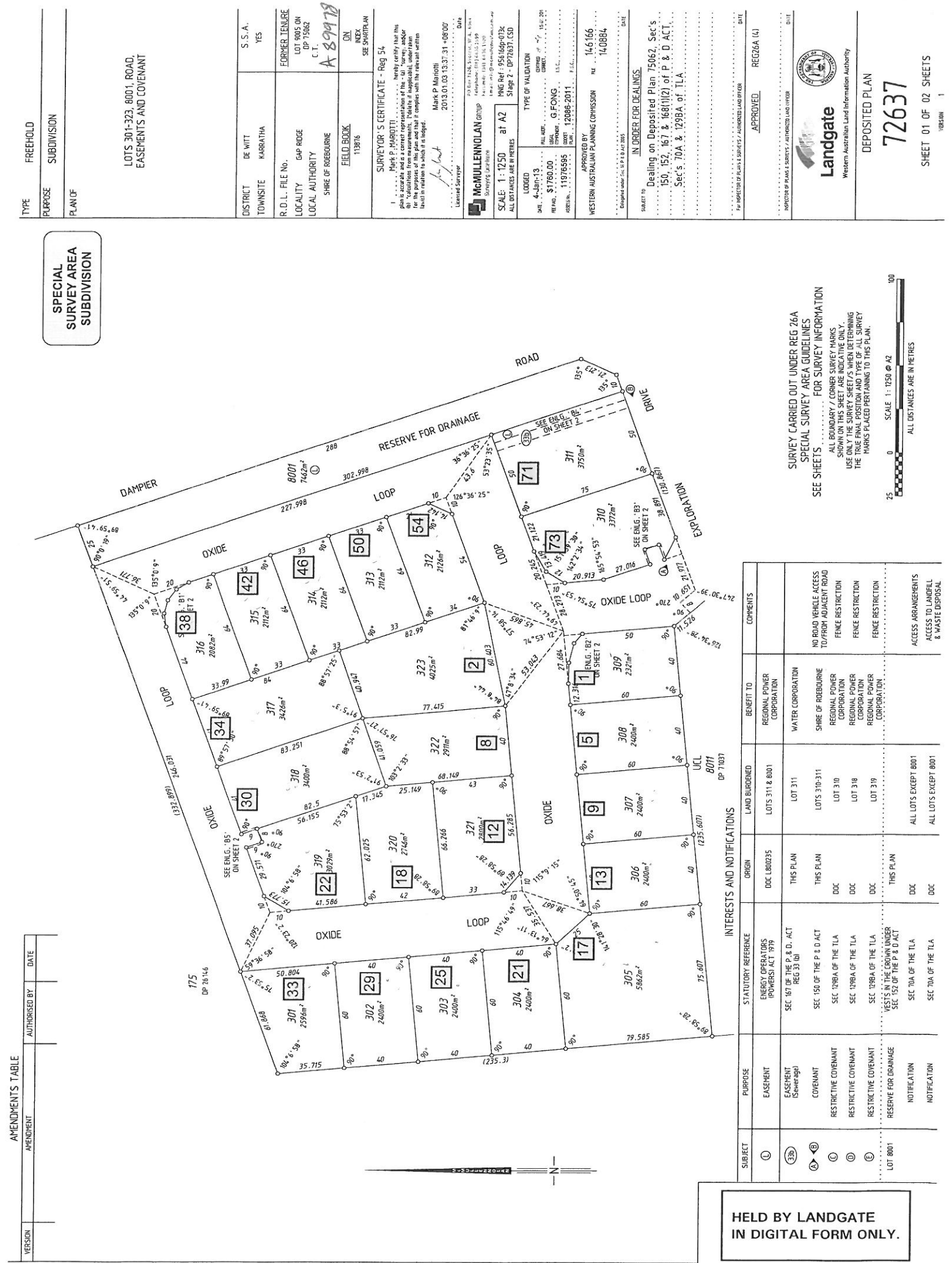

TYPE	FREEHOLD
PURPOSE	SUBDIVISION
PLAN OF	
LOTS 301-323, 8001, ROAD, EASEMENTS AND COVENANT	
DISTRICT	DE WITT
TOWNSITE	KARRATHA
R.D.L. FILE NO.	FORMER TENURE
LOCALITY	LOT 9005 ON DP 75062
LOCAL AUTHORITY	C.T.
SHIRE OF ROEBOURNE	A 89978
FIELD BOOK	113876
INDEX	SEE SHORPLAN
SURVEYOR'S CERTIFICATE - Reg 54	
I, Mark P. Marotti, hereby certify that this plan is a correct representation of the land shown on the survey sheet, and that the survey has been conducted in accordance with the provisions of the Survey Act 1968 and the Survey Regulations 1969.	
Mark P. Marotti	
2013.01.03 13:37:31 +0800	
McMULLENWOLAN GROUP	
2013.01.03 13:37:31 +0800	
MNG Ref: 95616dp-073C	
Stage 2 - DP72637, CSD	
ALL DISTANCES ARE IN METRES	
TYPE OF VALIDATION	
LOGGED	DATE
DATE	13
TIME	11:50:00
BY	G. FONG
REVIEWED	11/05/2013
APPROVED	12/08/2011
APPROVED BY	
WESTERN AUSTRALIAN PLANNING COMMISSION	
146166	
140884	
IN ORDER FOR DEALINGS	
Dealing on Deposited Plan 75062, Sec's 150, 152, 167 & 168(1)(2) of P & D ACT	
Sec's 70A & 1298A of TLA	
DATE	
2013.01.03 13:37:31 +0800	
APPROVED	
REC26A (4)	
DATE	
2013.01.03 13:37:31 +0800	
DIRECTOR OF LAND & SURVEY, AUSTRALIAN LAND REVENUE	
DATE	
2013.01.03 13:37:31 +0800	
Landgate	
Western Australian Land Information Authority	
DEPOSITED PLAN	
72637	
SHEET 01 OF 02 SHEETS	
VERSION 1	